

FOR SALE



CLOVER
RESIDENTIAL

PRESENTS

N1003-737 Humboldt St



DISCOVER

Downtown



Situated along Victoria's picturesque Inner Harbour, Downtown is a vibrant neighbourhood ideal for shopping, dining, and leisurely spending your day and night. Bike or walk, you're always near the waterfront as well as neighbouring urban villages.



\$469,000

Listed by:

Ole Schmidt & Michelle Matheson

Neighbourhood: Downtown

Bedrooms: 1

Bathrooms: 1

Living Area: 547 Sq.Ft. (Strata Plan)

Year Built: 2009

Taxes: \$2,614 (Tax Year: 2025)

Strata Fee: \$388.37

MLS: 1040009

#N1003 - 737 Humboldt St

Located in the most desirable pocket of Downtown Victoria, this Humboldt Valley condo puts you steps from everything the city has to offer! This 1 bed, 1 bath home features open-concept living with a well-appointed kitchen boasting granite countertops, gas range, dishwasher, and microwave, expansive windows that flood the space with natural light, engineered wood flooring, and a cozy gas fireplace. Enjoy north-facing views from your private balcony. Walk to Downtown, James Bay, the Inner Harbour, Cook St Village, and Beacon Hill Park - cafes, shops, dining, and green space all within easy reach. This exceptional building truly stands out, offering a fitness centre, sauna, steam room, lounge area, and resident caretaker/concierge service - amenities rarely found in one place. In-suite washer/dryer, secure underground parking, separate storage locker, and bike storage all included. A rare opportunity in one of Victoria's finest downtown locations!

FLOOR PLANS

UNIT N1003 - 737 HUMBOLDT STREET

546 SQ. FT.

8'-6" CEILING HEIGHT

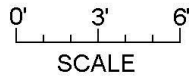
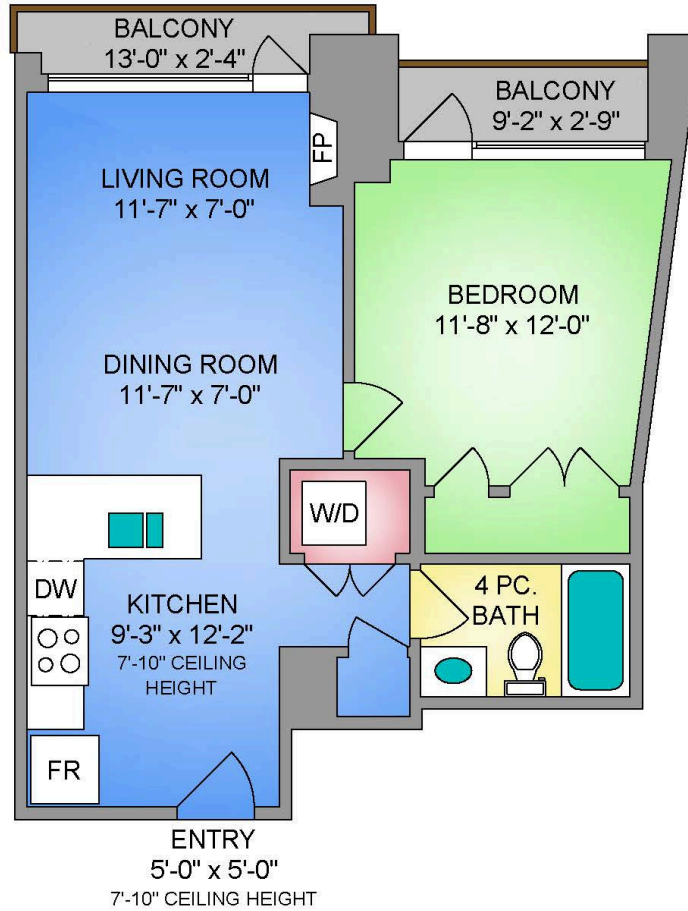

250-884-9753
matt@propermeasure.com
www.propermeasure.com

UNIT N1003 - 737 HUMBOLDT STREET JULY 2, 2026		
PREPARED FOR THE EXCLUSIVE USE OF CLOVER RESIDENTIAL LTD PLANS MAY NOT BE 100% ACCURATE, IF CRITICAL BUYER TO VERIFY.		
FLOOR	AREA (SQ. FT.)	
	FINISHED	BALCONY
TENTH	546	51



GET TO KNOW US



Ole Schmidt
**MANAGING BROKER,
CO-OWNER**



Michelle Matheson
**REALTOR®,
SALESTEAM**

EMAIL

Sales@CloverResidential.com

TEXT/CALL

250-383-7100



CLOVER
RESIDENTIAL