

FOR SALE



CLOVER
RESIDENTIAL

622 ADMIRALS RD.



CHARTWELL | VISTA

1009

PRESENTS

1009-622 Admirals Rd



DISCOVER

Esquimalt



Just minutes from Downtown Victoria, surrounded by water, and home to parks, beaches, and green spaces, Esquimalt offers a small-town feel and a strong sense of community.



\$1,249,000

Listed by:

Ole Schmidt & Michelle Matheson

Neighbourhood: Esquimalt

Bedrooms: 2

Bathrooms: 2

Living Area: 1,310 Sq.Ft. (Strata Plan)

Year Built: 2023

Taxes: \$7,523 (Tax Year: 2025)

Strata Fee: \$214,51

Vista Club Amenities Fees: \$1,300/mth
(+450 for additional occupant)

MLS: 1014803

1009-622 Admirals Rd

Experience comfort and community at Chartwell Vista's premier 55+ residence. This bright, west-facing 10th floor suite, the largest floor plan in the building, offers sweeping ocean and city views, filling the home with natural light. The open layout features a modern kitchen with quartz counters, two-tone cabinetry, paneled appliances, and oven with induction cooktop. Two spacious bedrooms, two full baths with heated floors, accessible walk-in shower, in-suite laundry, A/C, and versatile storage ensure comfort and convenience. Club fees include resort-style amenities on the spectacular top floor: full-service restaurant, tea room, lounges, fitness centre, library, art studio, rooftop deck with BBQs and fireplace, plus concierge, breakfast, high tea, and 24/7 emergency response. With TWO underground secure parking spots, FOB access, pet-friendly policy, and immediate possession, this is a rare opportunity to embrace vibrant retirement living in the heart of Esquimalt.

UNIT 1009 - 622 ADMIRALS ROAD
1310 SQ. FT.
8'-10" CEILING HEIGHT

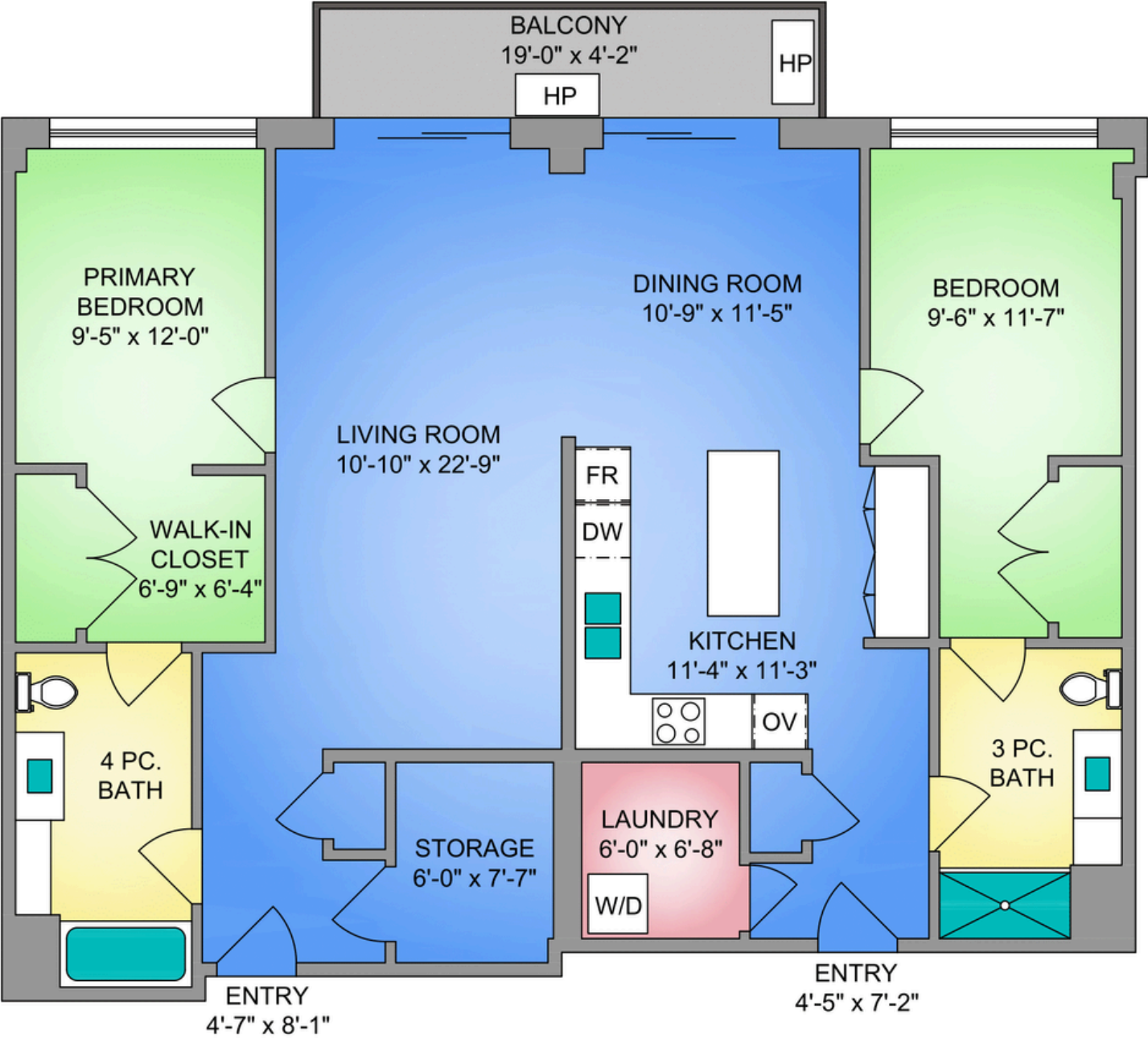

NORTH



250-884-9753
matt@propermeasure.com
www.propermeasure.com

UNIT 1009 - 622 ADMIRALS ROAD		
SEPTEMBER 29, 2025		
PREPARED FOR THE EXCLUSIVE USE OF CLOVER RESIDENTIAL LTD		
PLANS MAY NOT BE 100% ACCURATE, IF CRITICAL BUYER TO VERIFY.		
FLOOR	AREA (SQ. FT.)	
	FINISHED	BALCONY
TENTH	1310	78



GET TO KNOW THE SALES TEAM

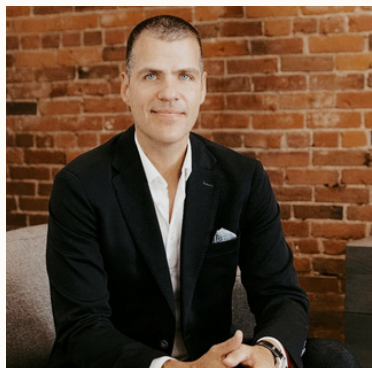

Ole Schmidt
MANAGING BROKER,
CO-OWNER, REALTOR®



Hannah Hayworth
REALTOR®



William Johnson
REALTOR®



Michelle Matheson
REALTOR®

EMAIL

Folio@CloverResidential.com

TEXT/CALL

250-256-8371

[CLOVERRESIDENTIAL.COM](https://CloverResidential.com)

Clover Residential Ltd. | 394 Moss Street, Victoria, BC, V8V 4N1

THE
FOLIO GROUP



CLOVER
RESIDENTIAL