

UNIT 405 - 838 BROUGHTON STREET
564 SQ. FT.
 8'-5" CEILING HEIGHT

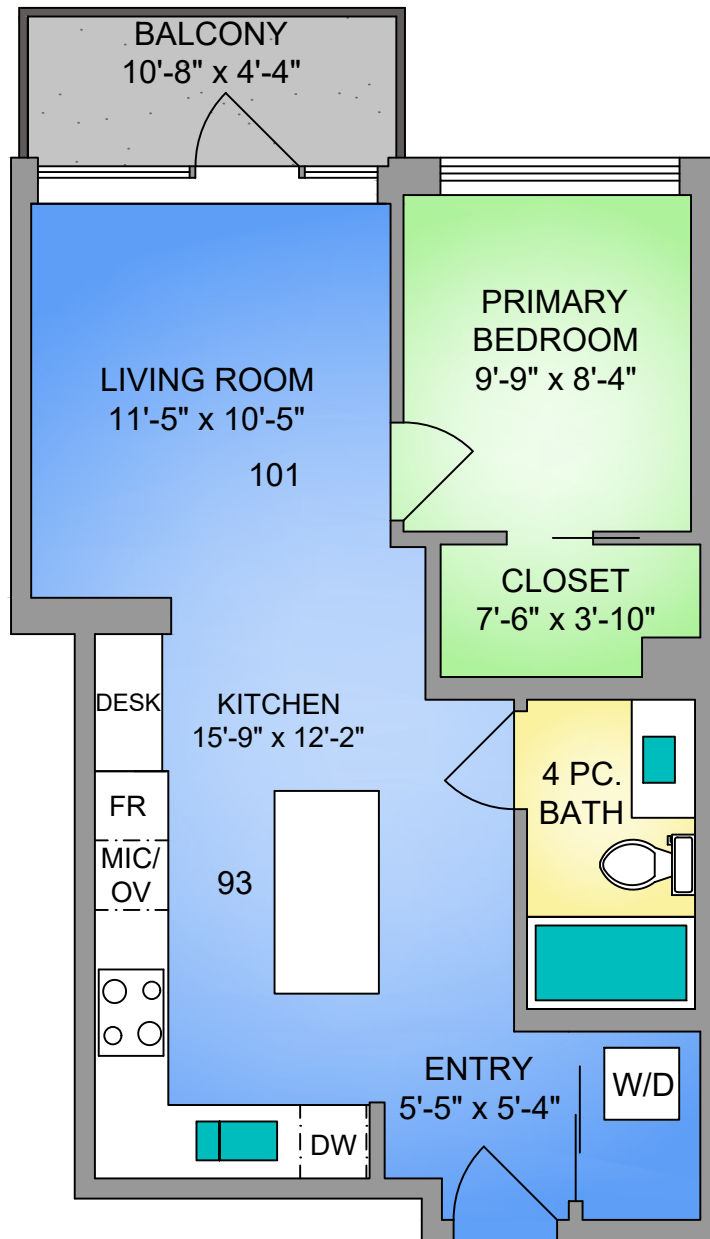

250-884-9753
 matt@propermeasure.com
 www.propermeasure.com

NORTH

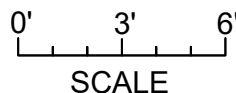
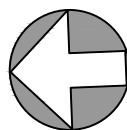

UNIT 405 - 838 BROUGHTON STREET
 SEPTEMBER 08, 2025

PREPARED FOR THE EXCLUSIVE USE OF CLOVER RESIDENTIAL LTD
 PLANS MAY NOT BE 100% ACCURATE, IF CRITICAL BUYER TO VERIFY.

FLOOR	AREA (SQ. FT.)	
	FINISHED	BALCONY
FOURTH	564	48