

## FIRST FLOOR

486 SQ. FT.

9' CEILING HEIGHT

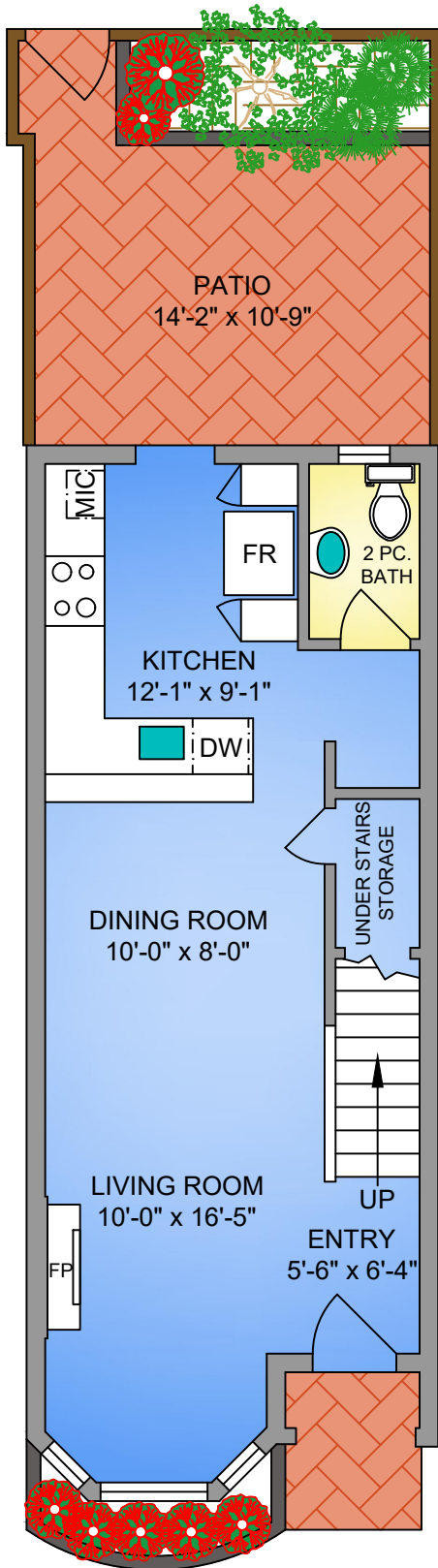

## SECOND FLOOR

530 SQ. FT.

8' CEILING HEIGHT

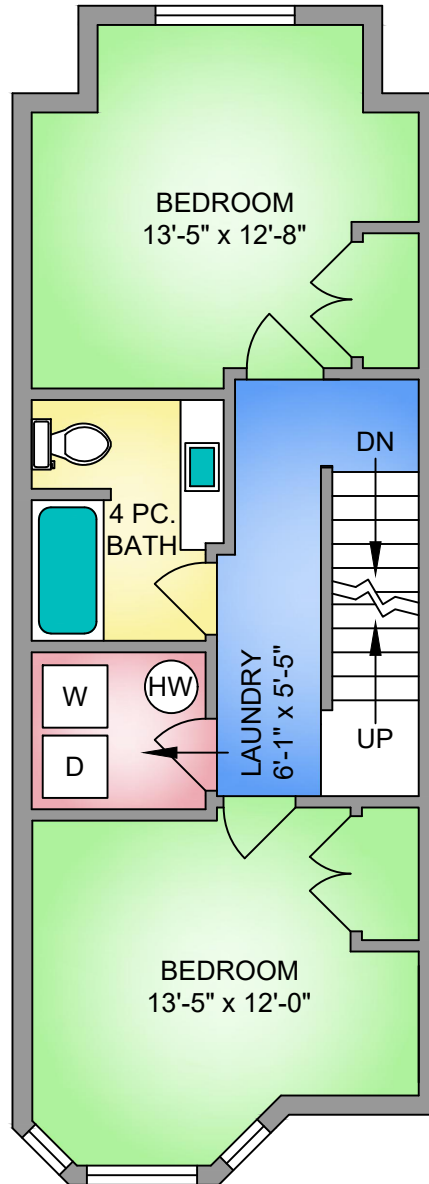

## THIRD FLOOR

435 SQ. FT.

8' CEILING HEIGHT

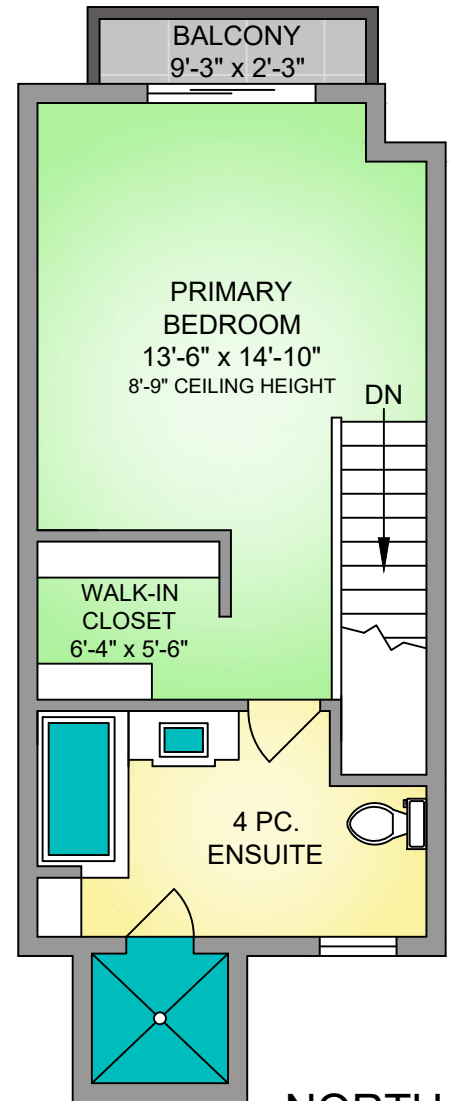

NORTH

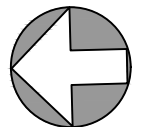
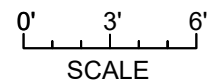

UNIT 17 - 675 SUPERIOR STREET		
SEPTEMBER 4, 2025		
PREPARED FOR THE EXCLUSIVE USE OF CLOVER RESIDENTIAL. PLANS MAY NOT BE 100% ACCURATE, IF CRITICAL BUYER TO VERIFY.		
FLOOR	AREA (SQ. FT.)	
	FINISHED	BALCONY / PATIO
FIRST	486	166
SECOND	530	-
THIRD	435	20
TOTAL	1451	186