

UNIT 305 - 1151 OSCAR STREET
683 SQ. FT.
8'-0" CEILING HEIGHT

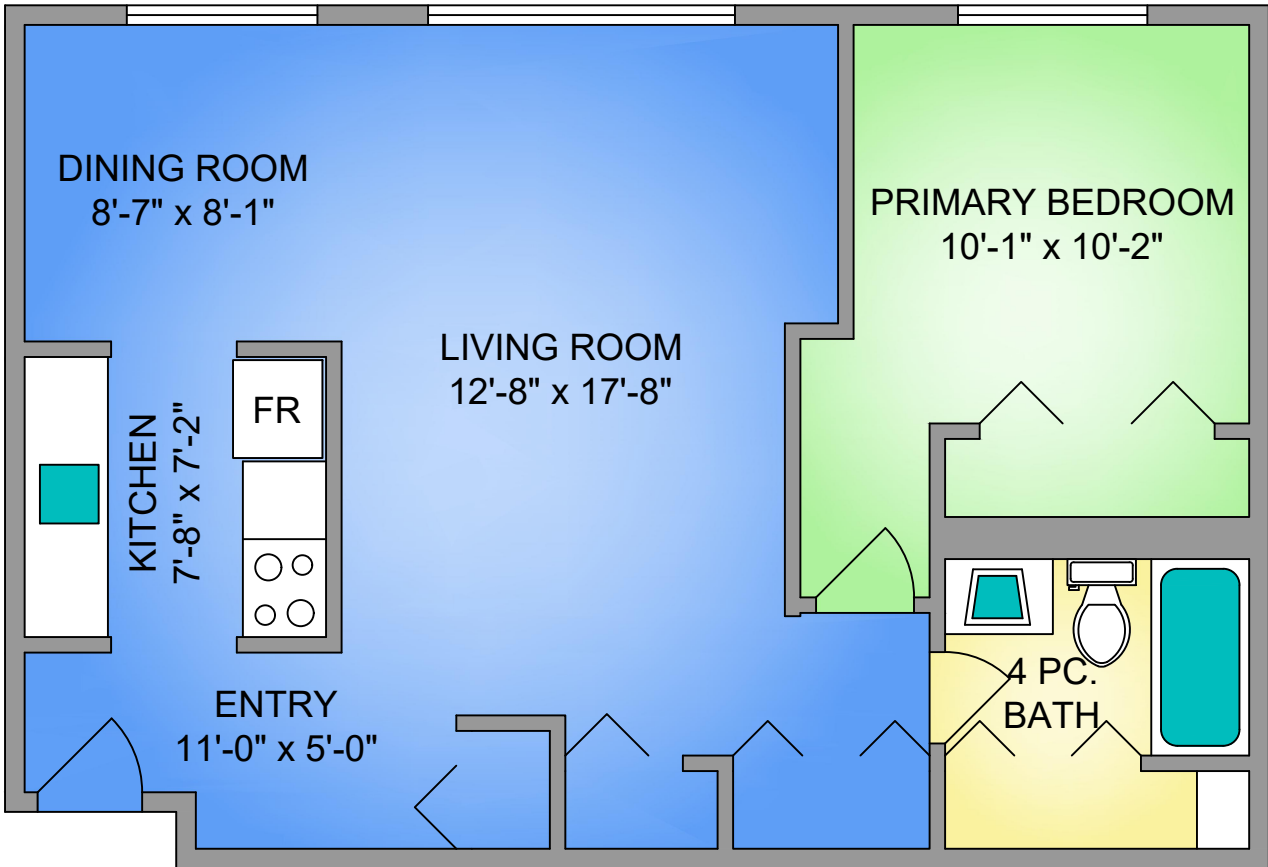

NORTH

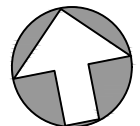
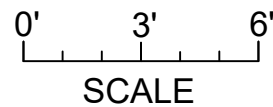

THE
FOLIO GROUP



250-884-9753
matt@propermeasure.com
www.propermeasure.com



UNIT 305 - 1151 OSCAR STREET JULY 8, 2025 PREPARED FOR THE EXCLUSIVE USE OF CLOVER RESIDENTIAL. PLANS MAY NOT BE 100% ACCURATE, IF CRITICAL BUYER TO VERIFY.	
FLOOR	AREA (SQ. FT.) FINISHED
THIRD	683