

UNIT 310 - 2647 GRAHAM STREET
 602 SQ. FT.
 8'-0" CEILING HEIGHT

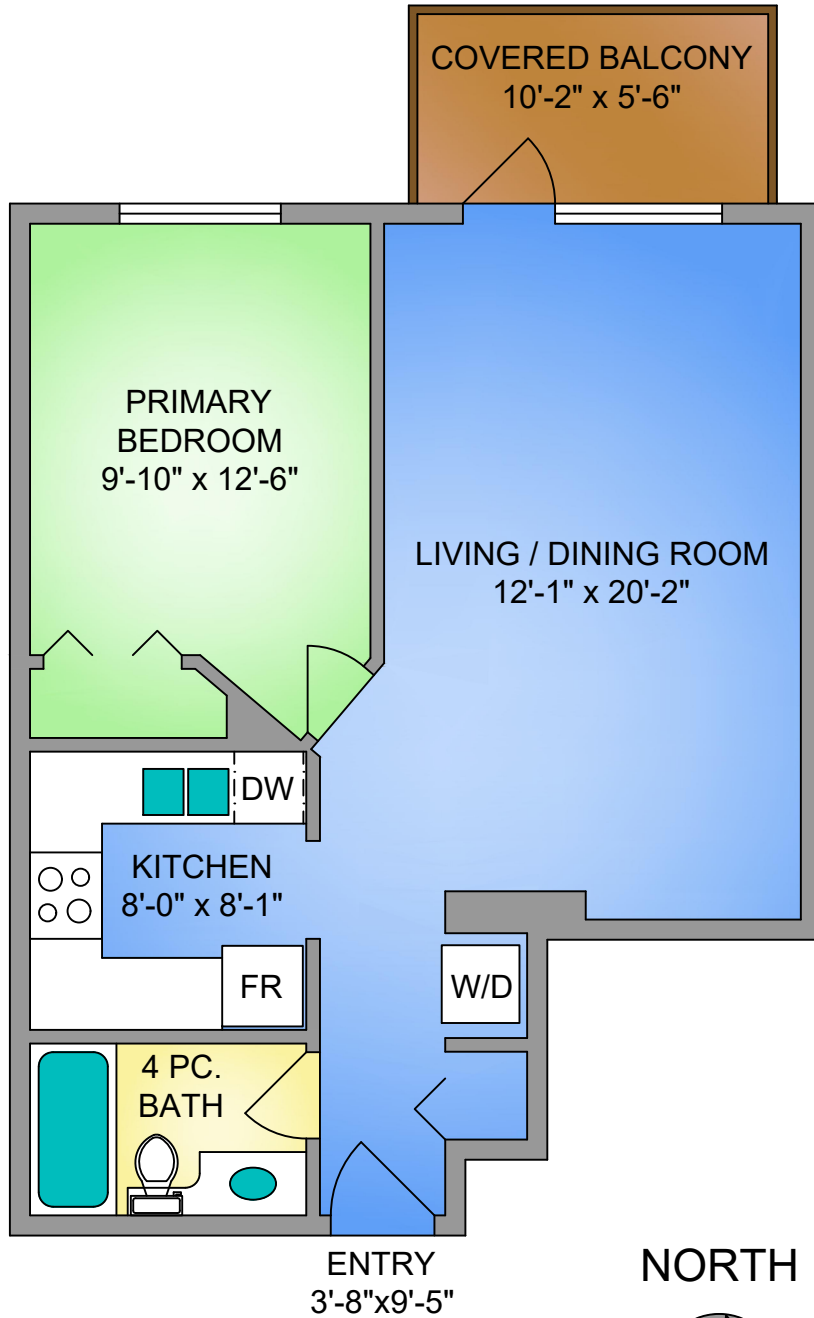

NORTH

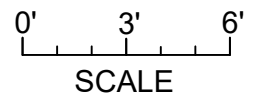
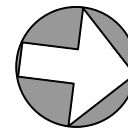

CLOVER
RESIDENTIAL



250-884-9753
 matt@propermeasure.com
 www.propermeasure.com

UNIT 310 - 2647 GRAHAM STREET MARCH 24, 2025 PREPARED FOR THE EXCLUSIVE USE OF CLOVER RESIDENTIAL PLANS MAY NOT BE 100% ACCURATE, IF CRITICAL BUYER TO VERIFY.		
FLOOR	AREA (SQ. FT.)	
	FINISHED	BALCONY
THIRD	602	56