

FOR SALE



CLOVER
RESIDENTIAL

THE
FOLIO
GROUP
PRESENTS

111-1100 Yates St

DISCOVER

Downtown



Situated along Victoria's picturesque Inner Harbour, Downtown is a vibrant neighbourhood ideal for shopping, dining, and leisurely spending your day and night. Bike or walk, you're always near the waterfront as well as neighbouring urban villages.



\$475,000

Listed by: Ole Schmidt, Hannah Hayworth & William Johnson

Neighbourhood: Downtown

Bedrooms: 1

Bathrooms: 1

Living Area: 485 Sq.Ft. (Strata Plan)

Year Built: 2024

Taxes: \$0 (Tax Year: 2024)

Strata: \$276

MLS: 991241

1111-1100 Yates St

Welcome to NEST - Luxury Living in the Heart of Victoria! Step into this stunning 1-bedroom, 1-bath condo, designed for modern comfort and style. The chef-inspired kitchen boasts Fisher & Paykel appliances, quartz countertops, and sleek European cabinetry. Unwind in your spa-like bath with heated porcelain tile floors and a deep soaker tub, or relax in the open-concept living space with floor-to-ceiling windows and wood-look luxury vinyl plank flooring. Stay comfortable year-round with suite-controlled A/C and heating, then step onto your private 100 sq ft balcony to soak in views of the Olympic Mountain Range and buzzing Downtown area. Plus, enjoy the common fitness room, bike storage, insuite laundry, and a separate storage locker—all in a walkable neighbourhood where you won't need a car.

UNIT 1111 - 1100 YATES STREET
485 SQ. FT.
8'-8" CEILING HEIGHT

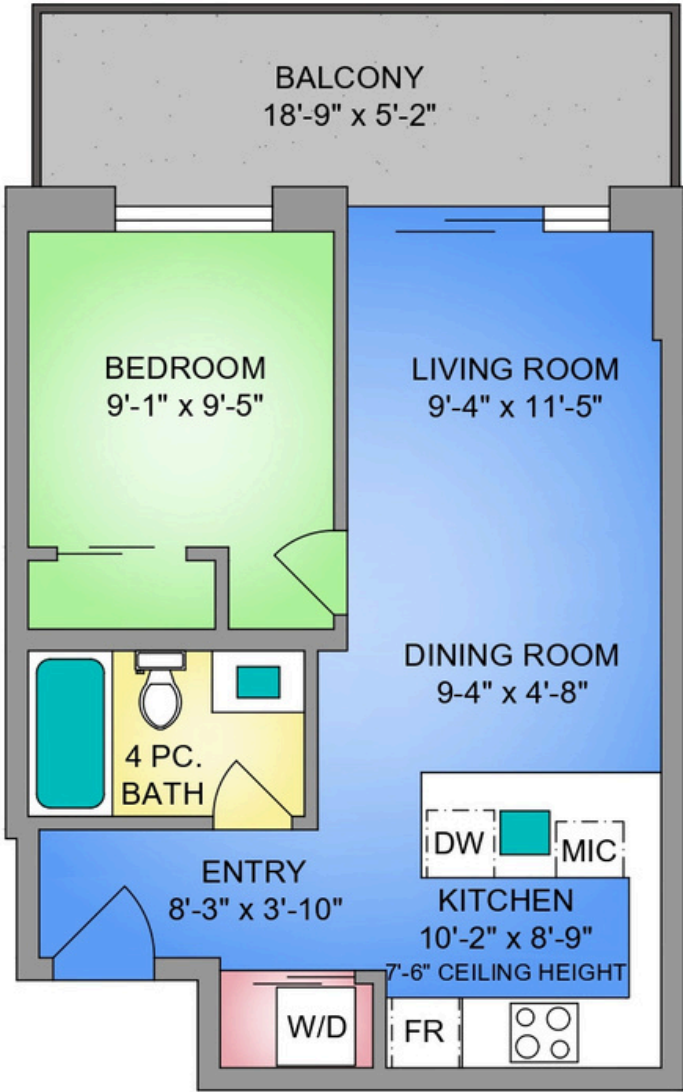

THE
FOLIO GROUP



250-884-9753
matt@propermeasure.com
www.propermeasure.com

NORTH

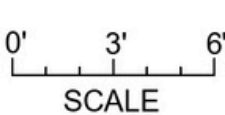

UNIT 1111 - 1100 YATES STREET		
MARCH 19, 2025		
PREPARED FOR THE EXCLUSIVE USE OF CLOVER RESIDENTIAL LTD		
PLANS MAY NOT BE 100% ACCURATE, IF CRITICAL BUYER TO VERIFY.		
FLOOR	AREA (SQ. FT.)	
	FINISHED	BALCONY
ELEVENTH	485	104



GET TO KNOW US



Ole Schmidt
MANAGING BROKER,
CO-OWNER

William Johnson
REALTOR®,
SALES TEAM

Hannah Hayworth
REALTOR®,
SALES TEAM

EMAIL

Folio@CloverResidential.com

TEXT/CALL

250-256-8371

CLOVERRESIDENTIAL.COM

Clover Residential Ltd. | 394 Moss Street, Victoria, BC, V8V 4N1

THE
FOLIO GROUP



CLOVER
RESIDENTIAL