

FOR SALE



CLOVER
RESIDENTIAL

THE
FOLIO
GROUP

PRESENTS

703-646 Michigan St



DISCOVER

James Bay



Tucked behind the Legislature Buildings and the Inner Harbour, James Bay is one of Victoria's oldest neighbourhoods, with many original turn-of-the-century Victorian homes.



\$619,000

Listed by:

Ole Schmidt, Hannah Hayworth & William Johnson

Neighbourhood: James Bay

Bedrooms: 1

Bathrooms: 1

Living Area: 640 Sq.Ft. (strata plan)

Year Built: 2014

Taxes: \$3,070 (Tax Year: 2024)

Strata Fee: \$448

703-646 Michigan St

MLS: 984858

Experience a stylish and sun-filled 1-bed unit that boasts unbeatable views of the Parliament Buildings and Harbour, located in the prestigious Duet building. Built in 2014 by reputable Chard Developments, this steel and concrete build sits on the border of historic James Bay and Downtown Victoria, creating endless appeal with vibrant yet quiet charm. Enjoy sunsets over the cityscape with floor to ceiling windows and a west-facing balcony w/ a gas BBQ hookup. The interior alike is sure to impress- an open concept living space featuring a gourmet kitchen with a large island, barstool seating, quartz counters, gas range, stainless appliances, and spacious pantry w/ insuite laundry. Engineered wood flooring is throughout, and the spa-inspired bath includes heated floors and a walk in waterfall shower. Amenities include a rooftop terrace, lounge area, underground parking, and storage locker. Steps from Beacon Hill Park, James Bay Village, and the ocean, this is luxury living at its best!

THE
FOLIO GROUP

FLOOR PLANS

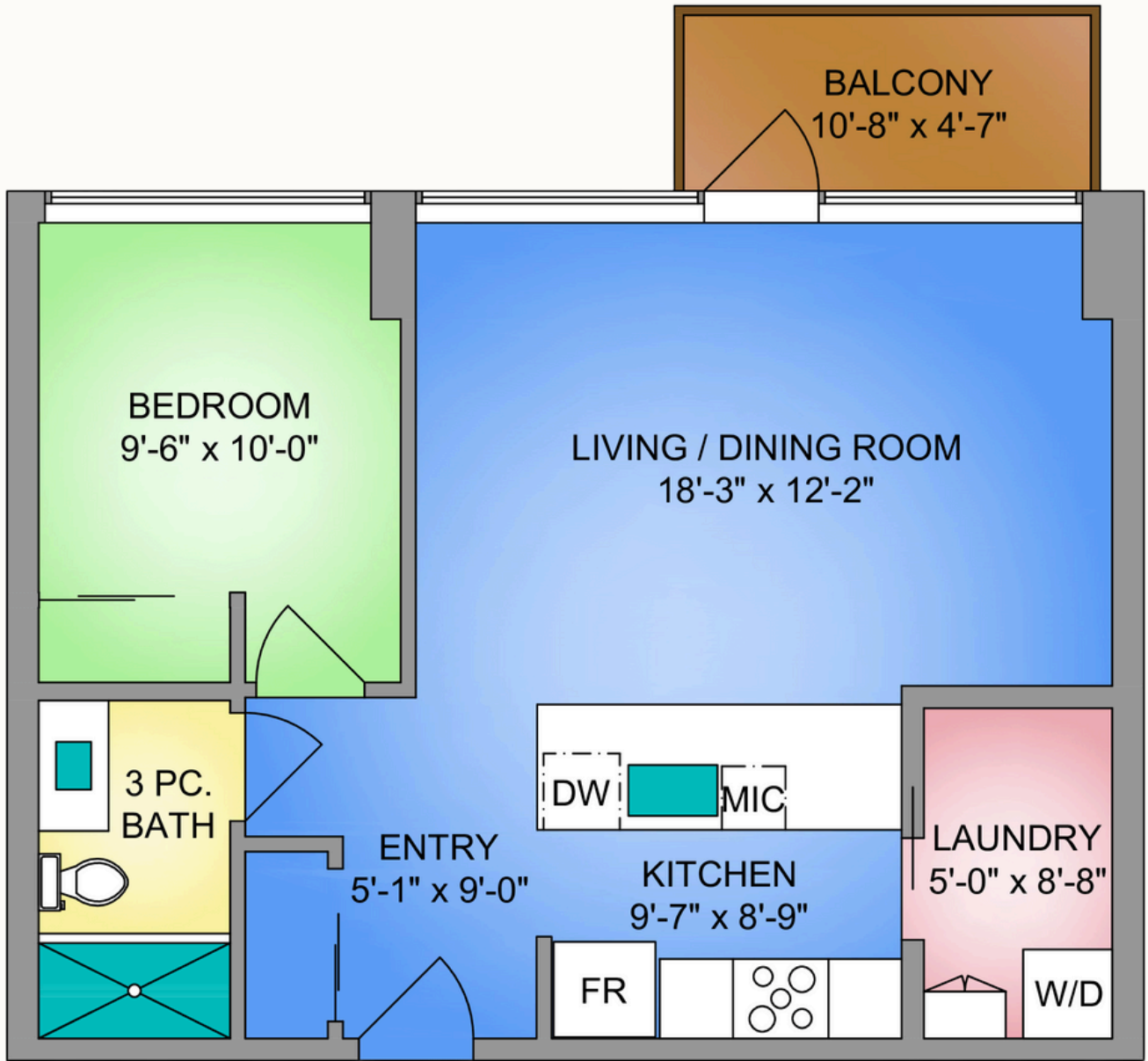



GET TO KNOW US

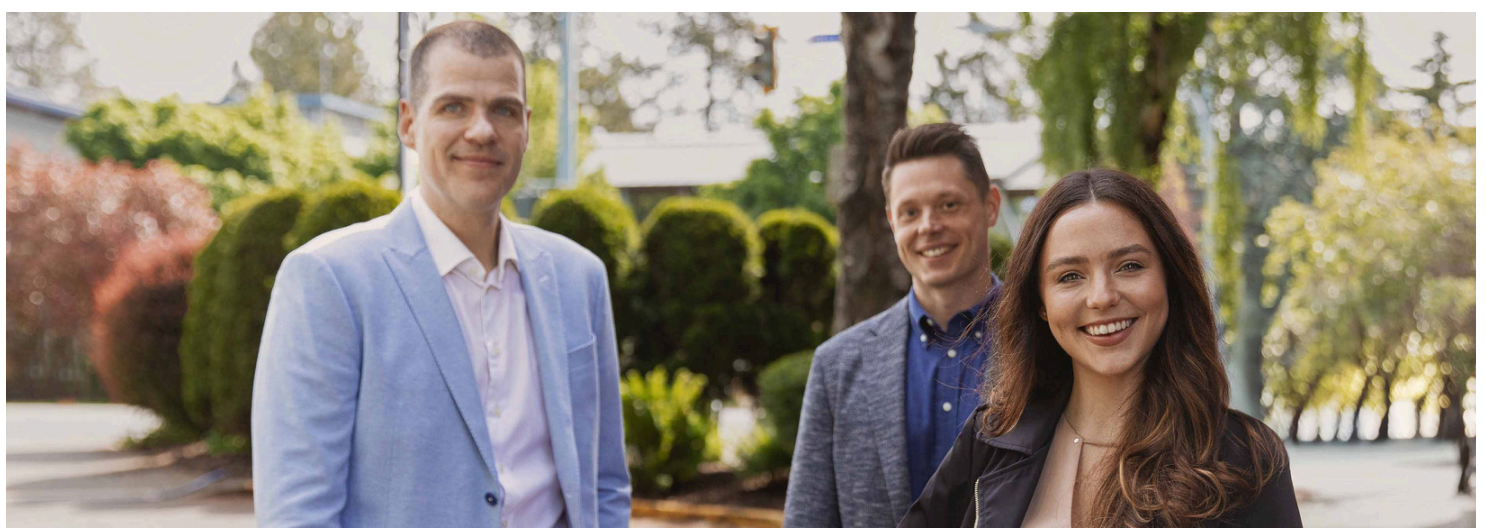

Ole Schmidt
MANAGING BROKER,
CO-OWNER

William Johnson
REALTOR®

Hannah Hayworth
REALTOR®

EMAIL
Folio@CloverResidential.com

TEXT/CALL
250-256-8371



CLOVER
RESIDENTIAL

THE
FOLIO
GROUP