

FOR SALE

THE
FOLIO
GROUP



CLOVER
RESIDENTIAL

PRESENTS

808-838 Broughton St

DISCOVER

Downtown



Situated along Victoria's picturesque Inner Harbour, Downtown is a vibrant neighbourhood ideal for shopping, dining, and leisurely spending your day and night. Bike or walk, you're always near the waterfront as well as neighbouring urban villages.



\$515,000

Listed by:

Ole Schmidt, Hannah Hayworth &
William Johnson

Neighbourhood: Downtown

Bedrooms: 1

Bathrooms: 1

Living Area: 576 Sq.Ft.

Year Built: 2017

Taxes: \$2,222 (Tax Year: 2023)

Strata Fee: \$360

MLS: 977747

808-838 Broughton St

Welcome to the Escher! Boasting a vibrant yet peaceful location within Downtown Victoria, you'll surely be impressed by this popular steel & concrete build by Chard Developments. Step into this beautifully presented 1-bed, 1-bath condo, featuring a spacious deck with coveted southern exposure and views of the Olympic Mountains. Built in 2017, this home blends contemporary style with convenience, making it the perfect urban retreat. Enjoy the ease of insuite laundry, secure underground parking, and dedicated bike storage, plus this pet-friendly building welcomes your furry companions. The Chard signature rooftop deck, complete with BBQs and cozy seating, is ideal for entertaining while taking in the panoramic 360° city view. Located in a great Downtown pocket near Christ Church Cathedral and Beacon Hill Park, this home provides a more quiet escape while still keeping your finger on the pulse of the city. Make sure to check out the unique range of amenities at the doorstep of the Escher.

UNIT 808 - 838 BROUGHTON STREET

576 SQ. FT.

8'-5" CEILING HEIGHT

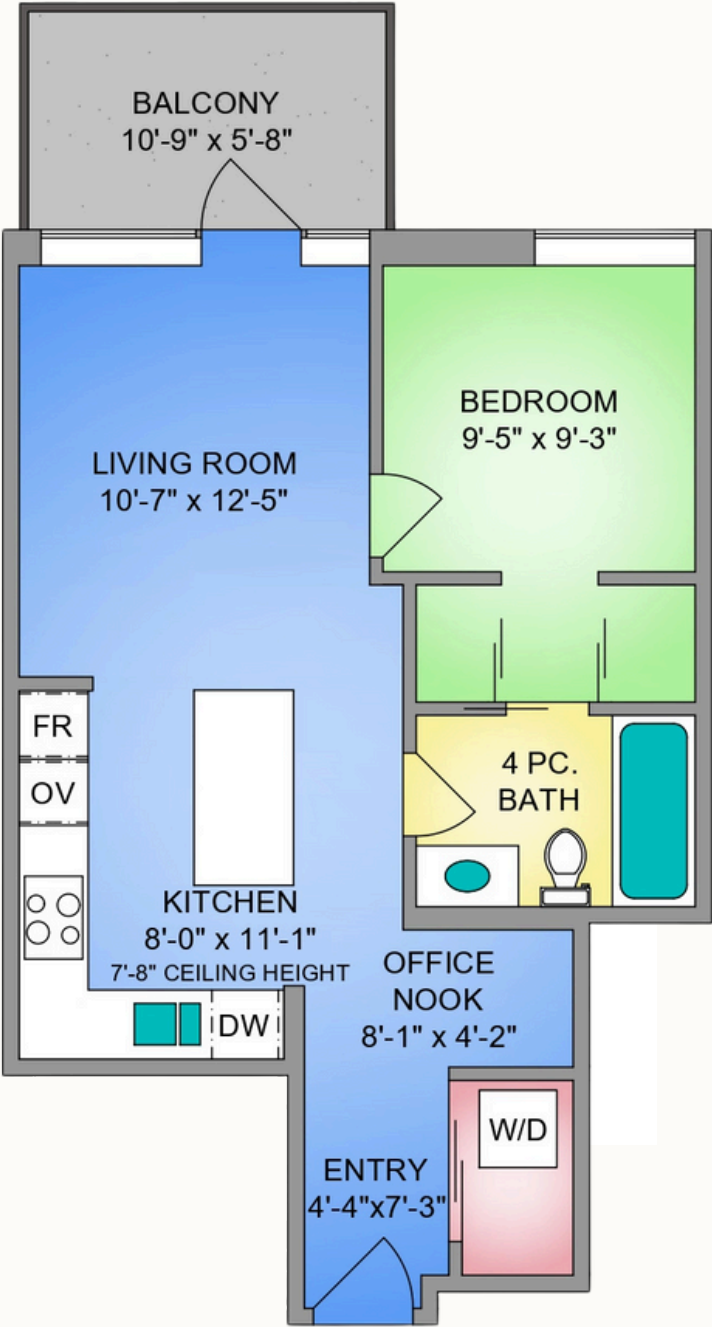



GET TO KNOW US

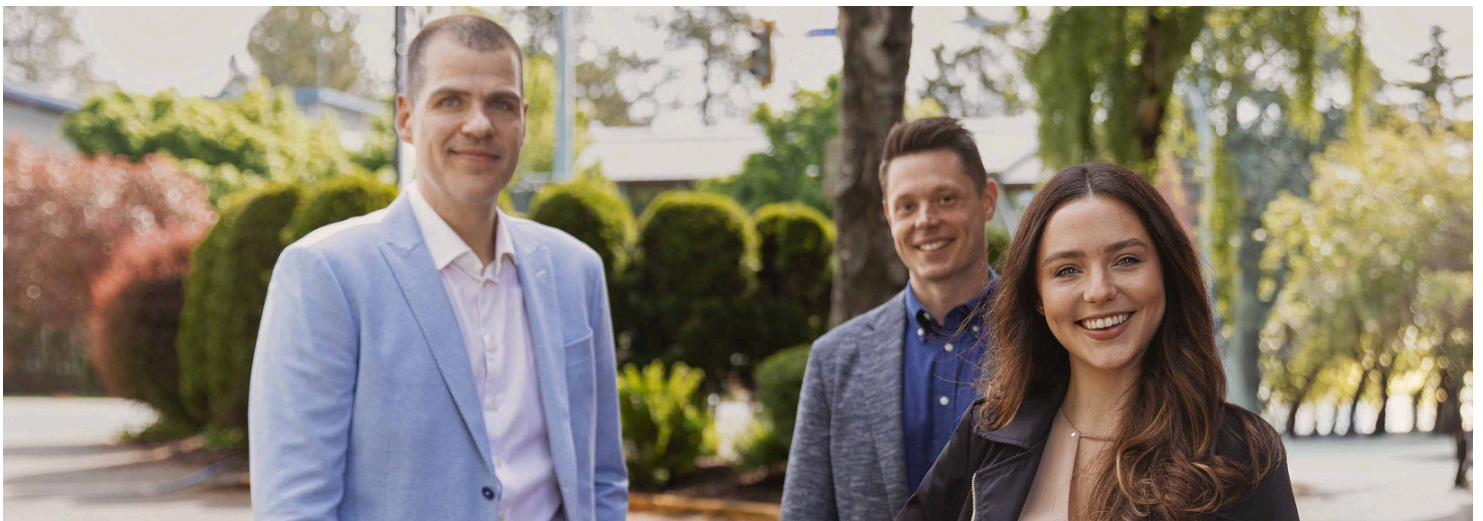

Ole Schmidt
MANAGING BROKER,
CO-OWNER

William Johnson
REALTOR®

Hannah Hayworth
REALTOR®

EMAIL

Folio@CloverResidential.com

TEXT/CALL

250-256-8371

CLOVERRESIDENTIAL.COM

Clover Residential Ltd. | 394 Moss Street, Victoria, BC, V8V 4N1

THE
FOLIO GROUP

THE
FOLIO
GROUP



CLOVER
RESIDENTIAL