

**UNIT 1011 - 989 JOHNSON STREET**  
**605 SQ. FT.**  
**8'-5" CEILING HEIGHT**

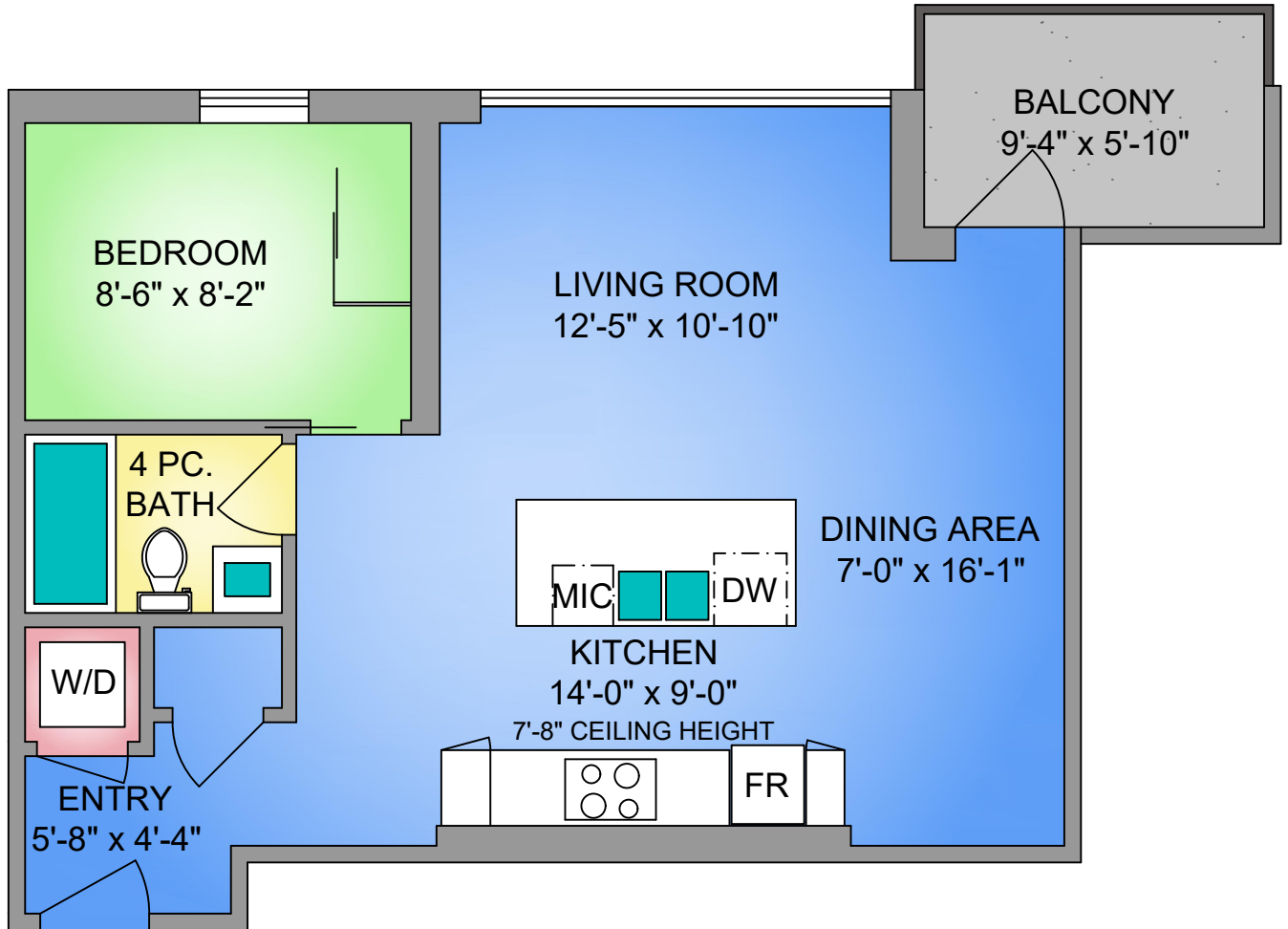

NORTH

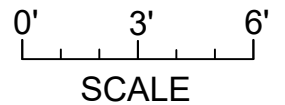
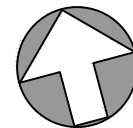

THE  
**FOLIO GROUP**



**PROPERMEASURE**  
 PRECISION

250-884-9753  
 matt@propermeasure.com  
 www.propermeasure.com

**CLOVER**  
 RESIDENTIAL

UNIT 1011 - 989 JOHNSON STREET		
OCTOBER 28, 2024		
PREPARED FOR THE EXCLUSIVE USE OF CLOVER RESIDENTIAL LTD PLANS MAY NOT BE 100% ACCURATE, IF CRITICAL BUYER TO VERIFY.		
FLOOR	AREA (SQ. FT.)	
	FINISHED	BALCONY
TENTH	605	55