

FOR SALE

THE  
**FOLIO  
GROUP**

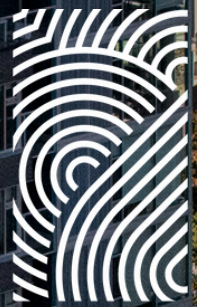

**CLOVER**  
RESIDENTIAL

PRESENTS

**1011-989 Johnson St**





DISCOVER

# Downtown



Situated along Victoria's picturesque Inner Harbour, Downtown is a vibrant neighbourhood ideal for shopping, dining, and leisurely spending your day and night. Bike or walk, you're always near the waterfront as well as neighbouring urban villages.





**\$519,000**

**Listed by:**

Ole Schmidt, Hannah Hayworth & William Johnson

---

**Neighbourhood:** Downtown

---

**Bedrooms:** 1

---

**Bathrooms:** 1

---

**Living Area:** 605 Sq.Ft.

---

**Year Built:** 2019

---

**Taxes:** \$2,485 (Tax Year: 2023)

---

**Strata Fee:** \$309

---

**MLS:** 979401

## 1011-989 Johnson St

Step into the heart of Downtown Victoria with this exceptional 10th-floor 1-bedroom, 1-bathroom condo at 989 Johnson. Ready for immediate possession! Designed for those who value quality and modern style, this home features engineered oak hardwood floors, a gourmet kitchen with high-end stainless steel appliances, quartz countertops, and custom cabinetry. Floor-to-ceiling windows flood the space with natural light, while the private balcony offers NE city views for a perfect urban retreat. As a resident of 989 Johnson, you'll enjoy thoughtful amenities including a south-facing courtyard with a yoga deck, secure underground parking, in-suite laundry, a storage locker, and bike storage. Plus, the building is pet-friendly, allowing one cat or one dog. This location places you just steps from boutique shops, cozy cafes, and all the delights of downtown, blending comfort and convenience for those seeking an active urban lifestyle!

**UNIT 1011 - 989 JOHNSON STREET**  
**605 SQ. FT.**  
**8'-5" CEILING HEIGHT**

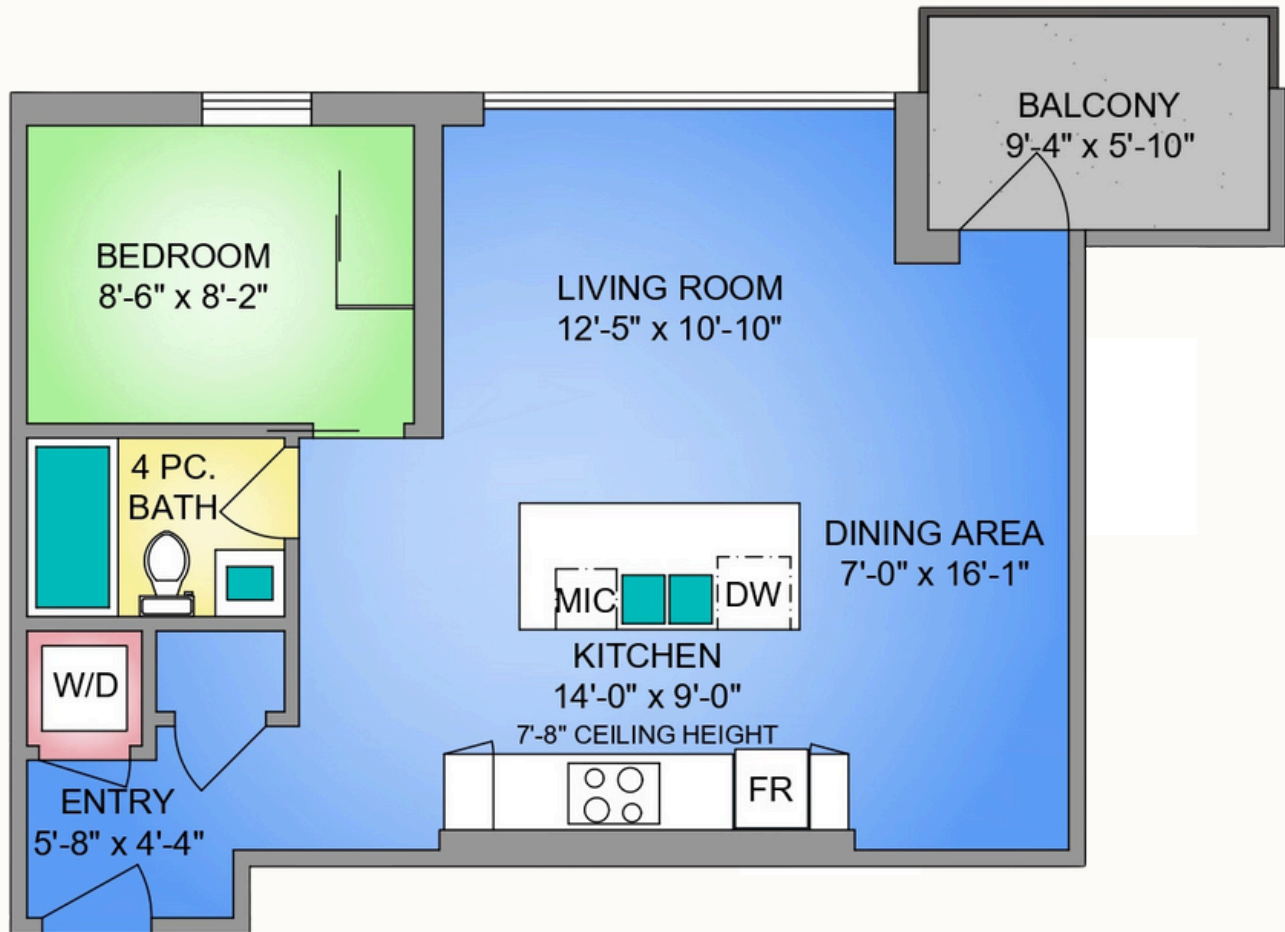





**GET TO KNOW US**



**Ole Schmidt**  
MANAGING BROKER,  
CO-OWNER

**William Johnson**  
REALTOR®

**Hannah Hayworth**  
REALTOR®

**EMAIL**

[Folio@CloverResidential.com](mailto:Folio@CloverResidential.com)

**TEXT/CALL**

250-256-8371



THE  
**FOLIO**  
**GROUP**



**CLOVER**  
RESIDENTIAL