

UNIT 303 - 1518 PANDORA AVENUE

1052 SQ. FT.

8'-0" CEILING HEIGHT

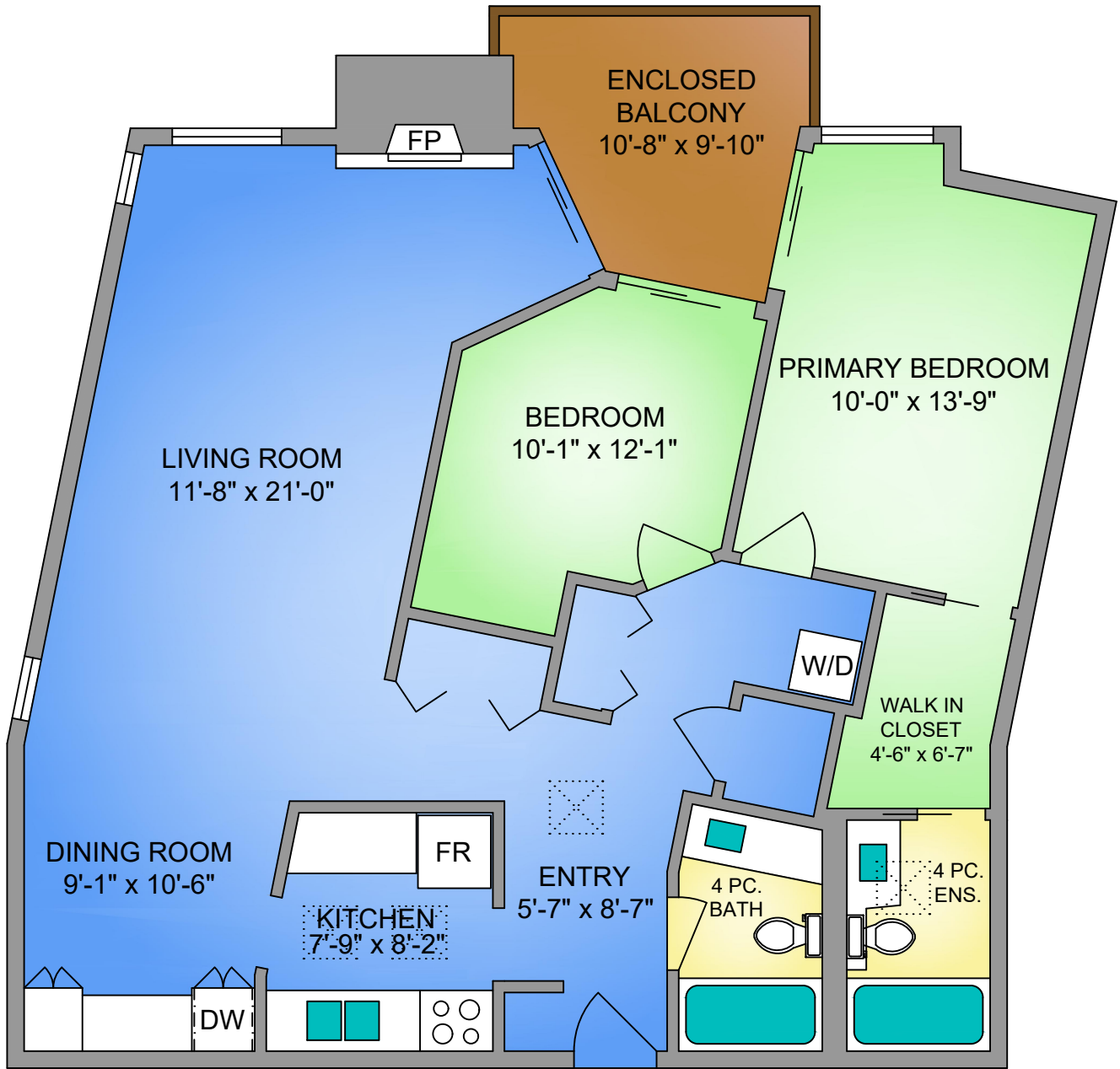

NORTH

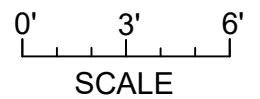
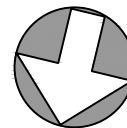

THE
FOLIO GROUP



250-884-9753
matt@propermeasure.com
www.propermeasure.com



CLOVER
RESIDENTIAL

UNIT 303 - 1518 PANDORA AVENUE		
JULY 29, 2024		
PREPARED FOR THE EXCLUSIVE USE OF CLOVER RESIDENTIAL LTD PLANS MAY NOT BE 100% ACCURATE, IF CRITICAL BUYER TO VERIFY.		
FLOOR	AREA (SQ. FT.)	
	FINISHED	BALCONY
THIRD	1052	79