

UNIT 301 - 1061 FORT STREET

318 SQ. FT.

8' TO 10' CEILING HEIGHT

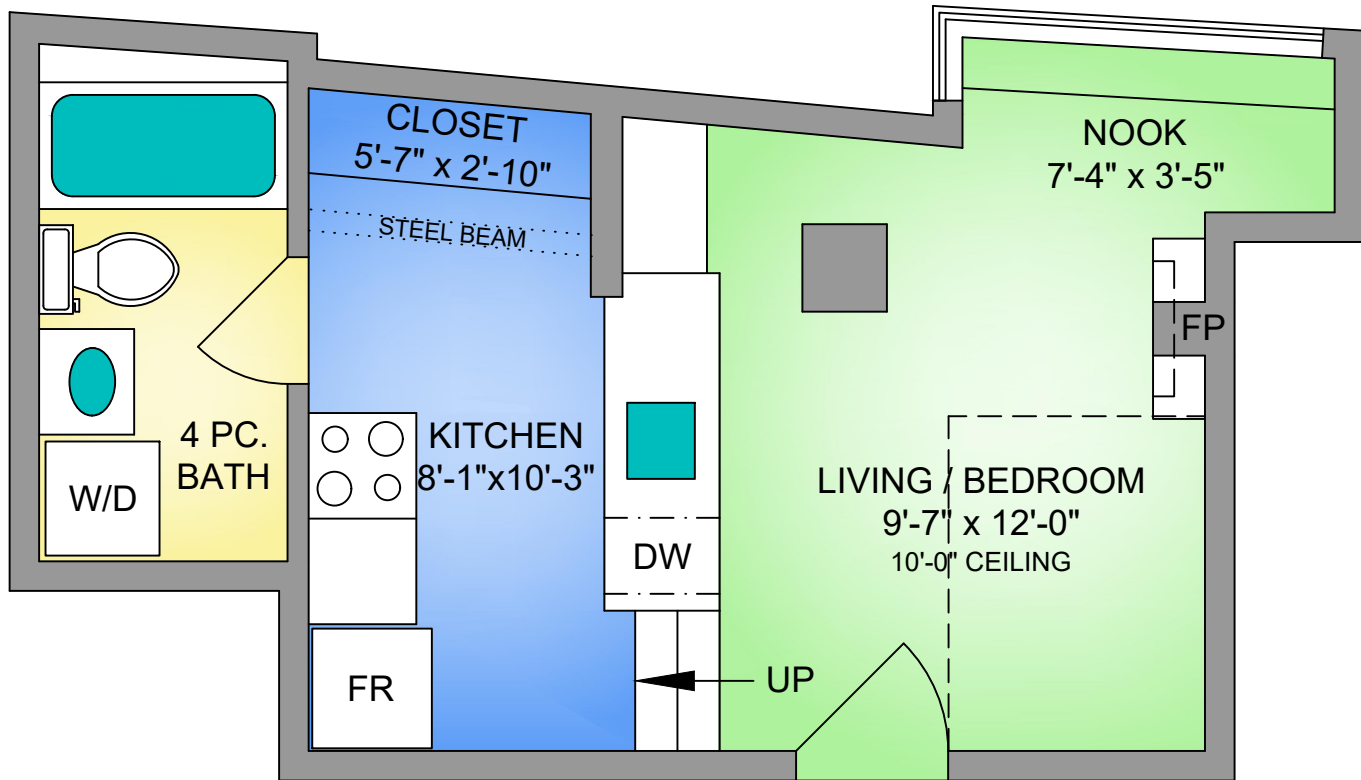

SLEEPING LOFT

37 SQ. FT.



NORTH

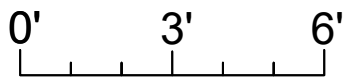
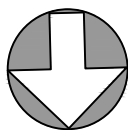

SCALE



250-884-9753
 matt@propermeasure.com
 www.propermeasure.com

CLOVER
 RESIDENTIAL

UNIT 301 - 1061 FORT STREET JULY 25, 2024	
<small>PREPARED FOR THE EXCLUSIVE USE OF CLOVER RESIDENTIAL PLANS MAY NOT BE 100% ACCURATE, IF CRITICAL BUYER TO VERIFY.</small>	
FLOOR	AREA (SQ. FT.)
	FINISHED
THIRD	318