

THE
FOLIO GROUP

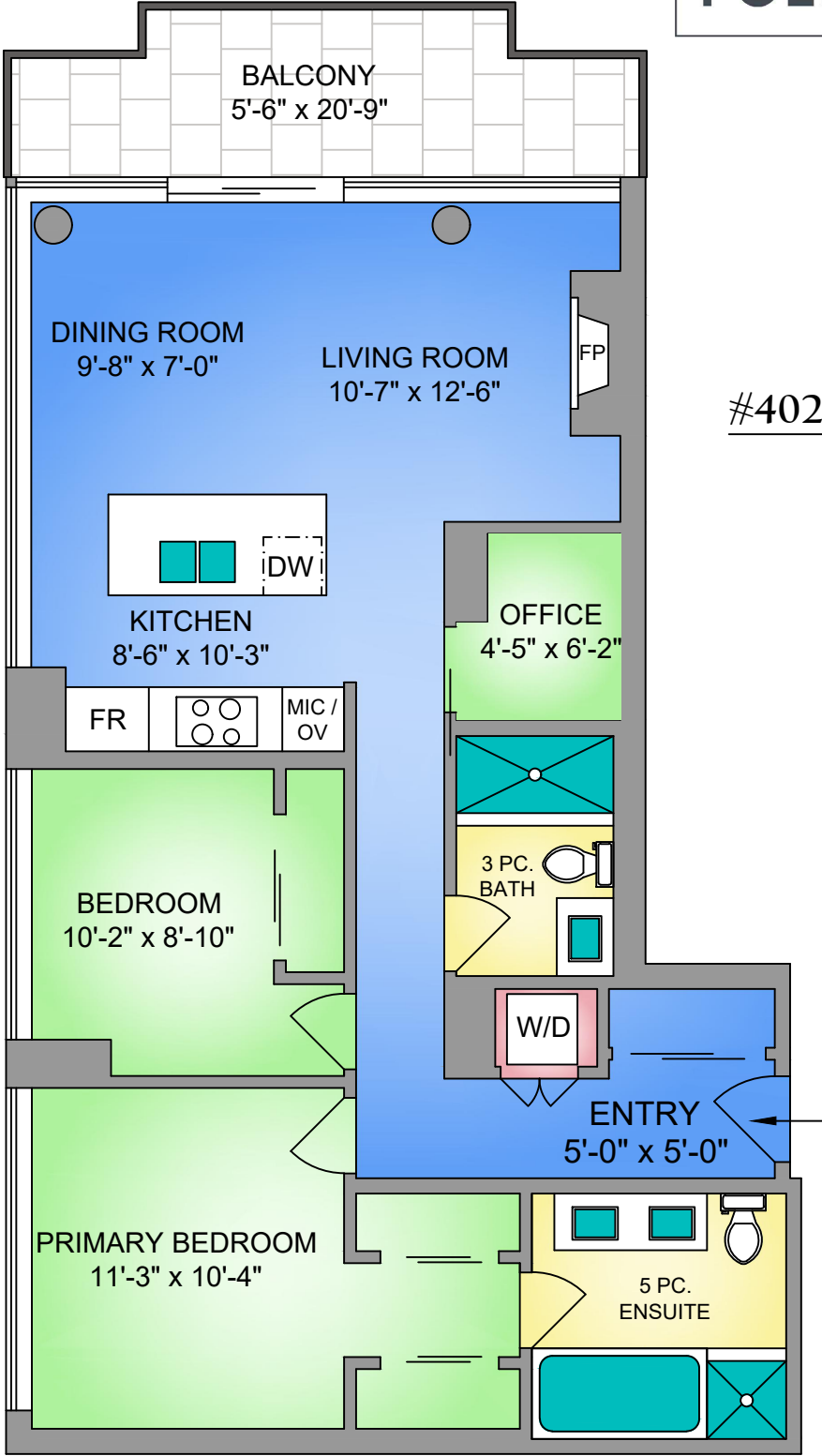

CLOVER
RESIDENTIAL



#402 - 708 BURDETT AVENUE
941 SQ. FT.
8'-5" CEILING HEIGHT

NORTH

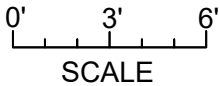
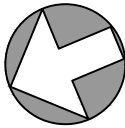

UNIT 402 - 708 BURDETT AVENUE APRIL 19, 2024 PREPARED FOR THE EXCLUSIVE USE OF CLOVER RESIDENTIAL LTD PLANS MAY NOT BE 100% ACCURATE, IF CRITICAL BUYER TO VERIFY.		
FLOOR	AREA (SQ. FT.)	
	FINISHED	BALCONY
FOURTH	941	101



250-884-9753
matt@propermeasure.com
www.propermeasure.com