

FOR SALE

THE
**FOLIO
GROUP**

PRESENTS

102-1101 Hilda St





DISCOVER

Fairfield



Equally hip and historic, Fairfield is one of Victoria's most desirable neighbourhoods. Park your car and start exploring—you're within walking distance of everything.



\$529,000

Neighbourhood: Fairfield

Bedrooms: 2

Bathrooms: 2

Living Area: 935 Sq.Ft.

Year Built: 1975

Lot Size: 1, 063 Sq.Ft.

Taxes: \$2,305 (Tax Year: 2023)

MLS: 954991

Strata Fee: \$492.42

102-1101 Hilda St

Prepare to fall in love with the undeniable charm of this delightful 2 bed, 1.5 bath garden patio condo, with updated kitchen and baths to ensure modern comfort & style. Boasting over 1000 sqft, this unit enjoys an abundance of natural light and an unbeatable location, just steps away from the vibrant Cook Street Village. Step out to your private enclosed sunroom & outdoor patio, surrounded by lush greenery on the southwest corner, providing a tranquil and versatile space to unwind. The primary bedroom is generously sized and features a convenient walkthrough closet w/ organizers, and a 2-pc ensuite. The building offers a range of amenities, including a workshop for your creative endeavors, a games room for entertainment, common laundry on the same level, and secure bike storage. Any parking is allocated by the strata council. With immediate possession possible, your new home awaits. Don't miss this opportunity to experience the perfect blend of charm, location, and style.

UNIT 102 - 1101 HILDA STREET
935 SQ. FT.
8' CEILING HEIGHT

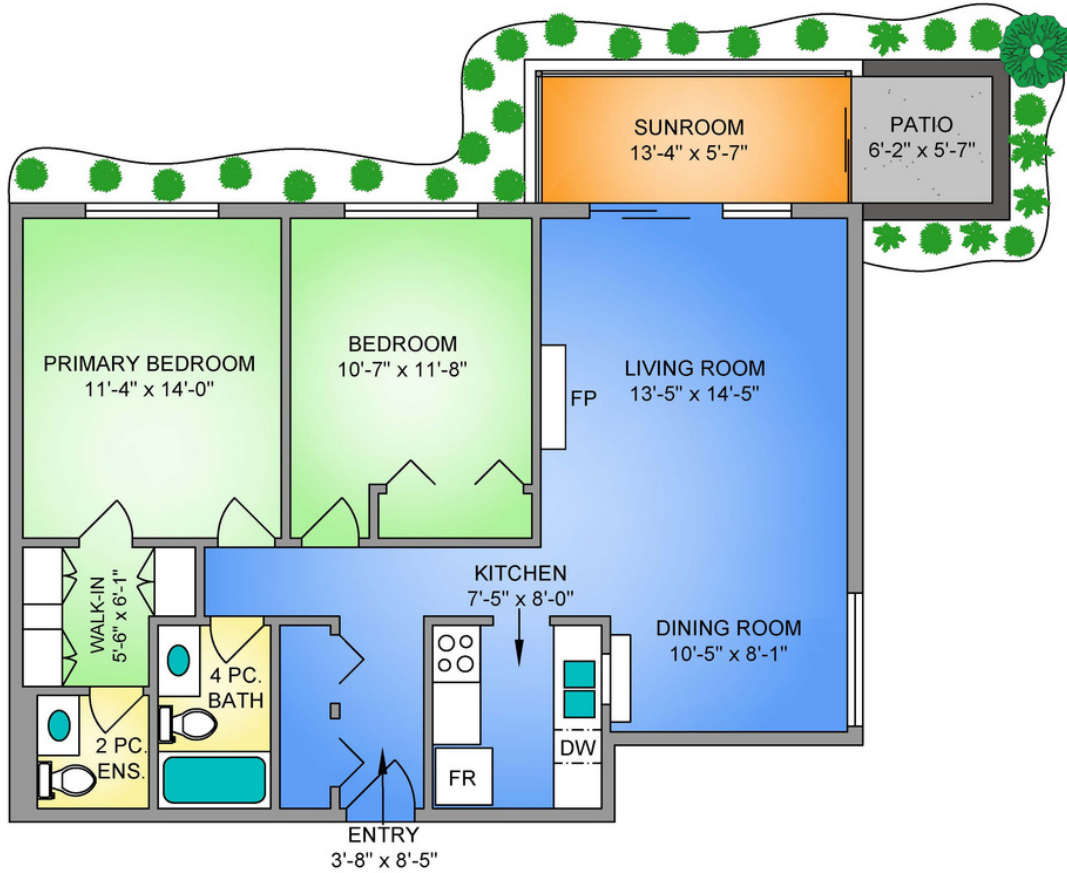

NORTH



UNIT 102 - 1101 HILDA STREET			
OCTOBER 13, 2023			
PREPARED FOR THE EXCLUSIVE USE OF CLOVER RESIDENTIAL			
PLANS MAY NOT BE 100% ACCURATE. IF CRITICAL BUYER TO VERIFY			
FLOOR	AREA (SQ. FT.)		
	FINISHED	SUNROOM	PATIO
FIRST	935	75	34



250-884-9753
 matt@propermeasure.com
 www.propermeasure.com



GET TO KNOW US



Ole Schmidt

MANAGING BROKER, CO-OWNER
Ole@cloverresidential.com



Hannah Hayworth

REALTOR®
Hannah@cloverresidential.com

THE
FOLIO
GROUP



CLOVER
RESIDENTIAL