

LOWER FLOOR
148 SQ. FT.
8' CEILING HEIGHT

THE FOLIO GROUP

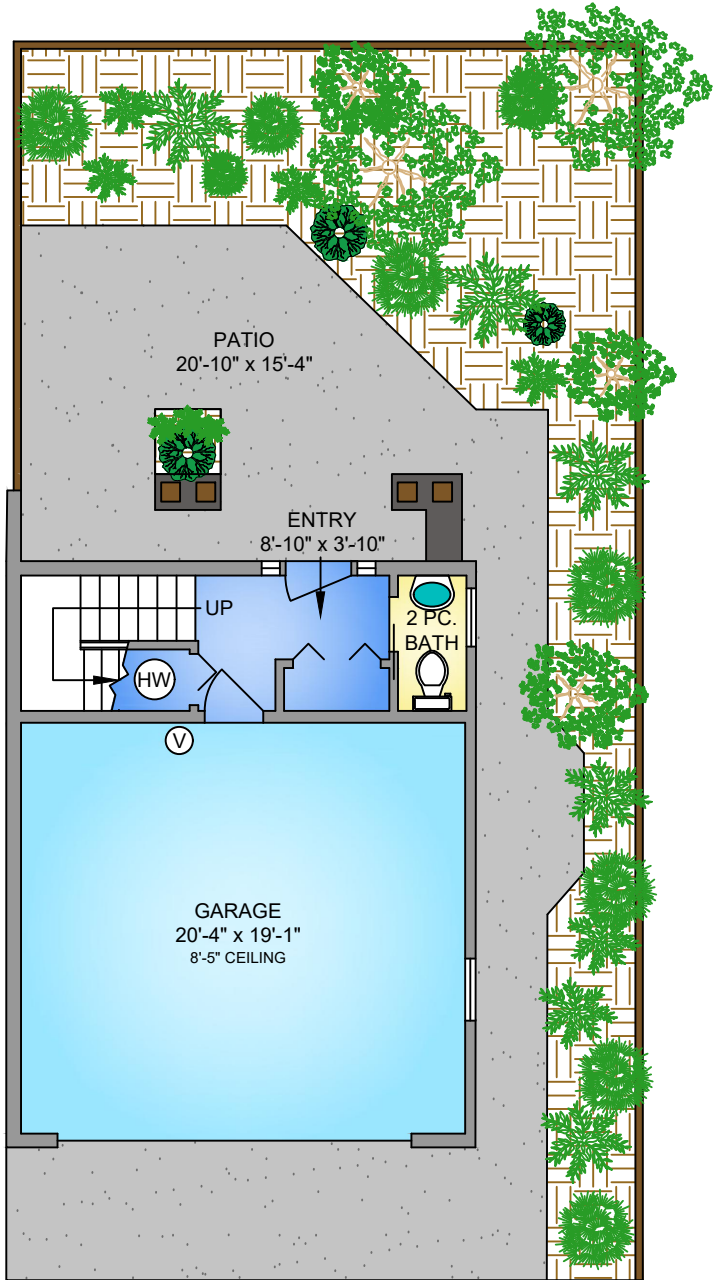

MAIN FLOOR
577 SQ. FT.
9' CEILING HEIGHT

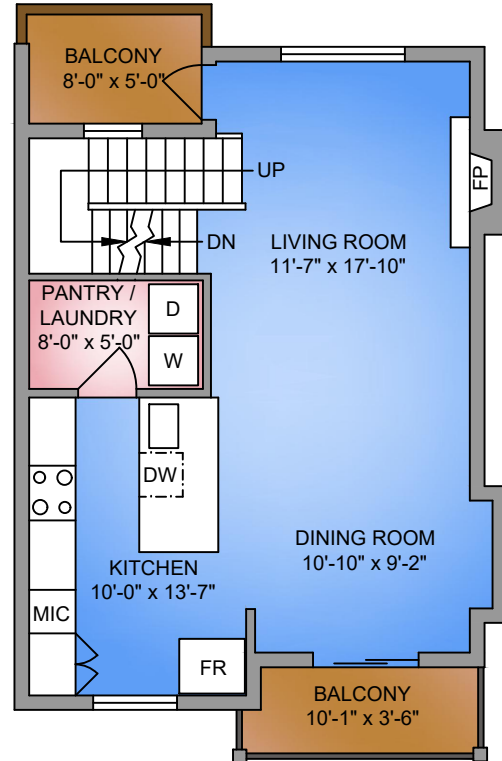

UPPER FLOOR
612 SQ. FT.
9' CEILING HEIGHT

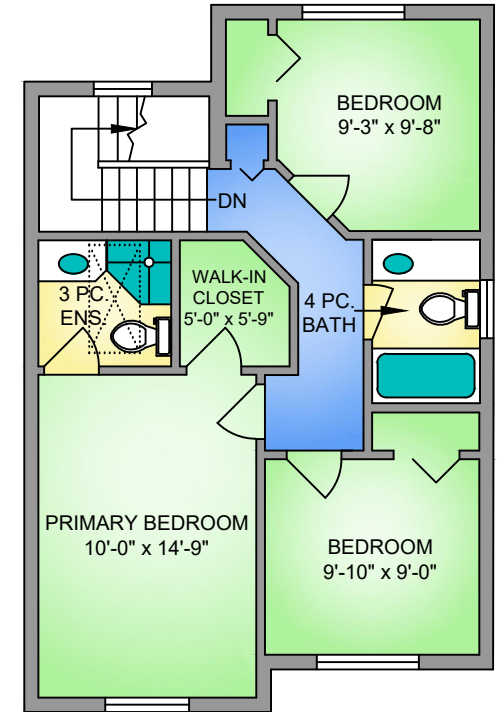

NORTH

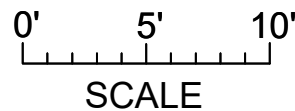
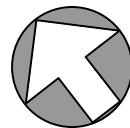

CLOVER
 RESIDENTIAL

UNIT 3 - 341 OSWEGO STREET			
MAY 26, 2023			
PREPARED FOR THE EXCLUSIVE USE OF CLOVER RESIDENTIAL			
PLANS MAY NOT BE 100% ACCURATE, IF CRITICAL BUYER TO VERIFY.			
FLOOR	AREA (SQ. FT.)		
	FINISHED	GARAGE	PATIO / BALC.
MAIN	577	-	80
UPPER	612	-	-
LOWER	148	399	282
TOTAL	1337	399	362