

FOR SALE

THE
**FOLIO
GROUP**

PRESENTS

#403-1090 Johnson Street





DISCOVER

Downtown



Situated along Victoria's picturesque Inner Harbour, Downtown is a vibrant neighbourhood ideal for shopping, dining, and leisurely spending your day and night. Bike or walk, you're always near the waterfront as well as neighbouring urban villages.



\$459,000

Neighbourhood: Downtown

Bedrooms: 1

Bathrooms: 1

Living Area: 541 Sq.Ft. (strata plan)

Year Built: 2013

Lot Size: 541 Sq.Ft. (strata plan)

Taxes: \$1,768 (Tax Year: 2022)

MLS: 933565

#403-1090 Johnson Street

Sophisticated 1 bedroom, 1 bath condo with desirable south facing exposure in a superb location on the edge of Downtown. Set in the popular steel and concrete Mondrian building, this is urban living at its finest. Efficient floor plan with well-appointed modern cabinetry, quartz countertops & stainless appliances in the kitchen, floor-to-ceiling windows, an abundance of natural light, gleaming floors, a south facing balcony, plus the convenience of an insuite washer/dryer unit. Walk to cafes, boutique shopping and groceries with the heart of Downtown mere blocks away. Or easily stroll/jog down to Cook St Village and the oceanfront. This impressive suite also includes an underground parking stall along w/separate storage locker & great bike storage in the building. Low strata fees, resident caretaker on site, and pets welcome!

UNIT 403 - 1090 JOHNSON STREET
540 SQ. FT.
 8'-6" CEILING HEIGHT

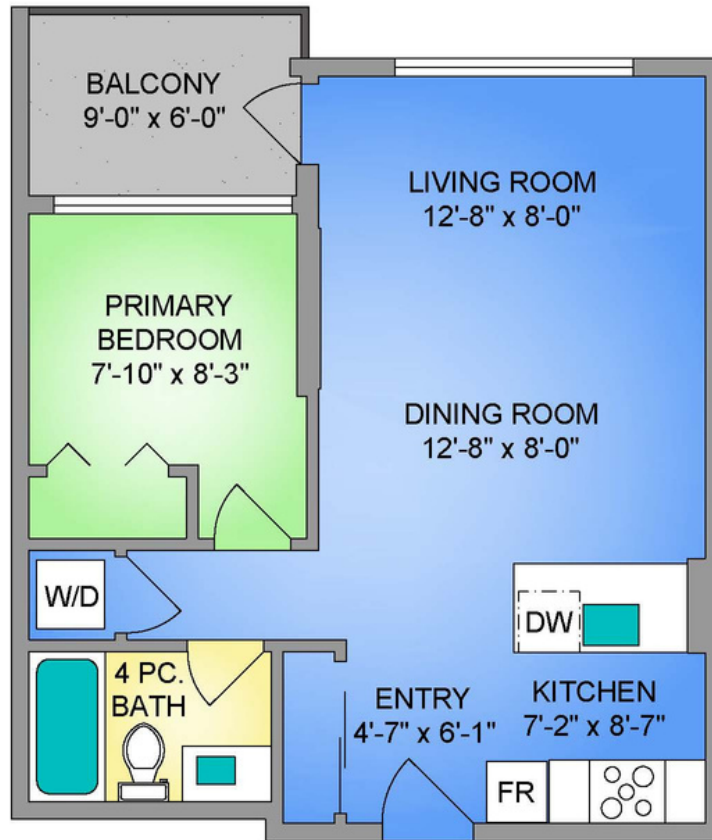

NORTH

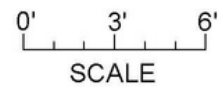

250-884-9753
 matt@propermeasure.com
 www.propermeasure.com

UNIT 403 - 1090 JOHNSON STREET		
JUNE 5, 2023		
PREPARED FOR THE EXCLUSIVE USE OF CLOVER RESIDENTIAL		
PLANS MAY NOT BE 100% ACCURATE, IF CRITICAL BUYER TO VERIFY.		
FLOOR	AREA (SQ. FT.)	
	FINISHED	BALCONY
FOURTH	540	53



GET TO KNOW US



Ole Schmidt

MANAGING BROKER, CO-OWNER
Ole@cloverresidential.com



Hannah Hayworth

REALTOR®
Hannah@cloverresidential.com

THE
**FOLIO
GROUP**



CLOVER
RESIDENTIAL